



# TruCore UPIX™

Core Orientation System



 VERACIO™





## TruCore™

TruCore UPIX™ is an easy-to-use, highly accurate core orientation system featuring step-by-step workflow guidance, wireless communication, and a field-replaceable battery. The patented TruCore UPIX orientation system fits hole sizes ranging from N to P with interchangeable adapters and barrel systems that are easily swapped whenever a change in hole size is required.

## 5 Reasons To Take Control With TruCore UPIX

1. TruCore UPIX provides accurate orientation and dip data that geologists, drillers, and engineers rely on.
2. Core orientation is easier with TruCore UPIX. There is no need to disassemble the core barrel to obtain an orientation mark.
3. Full-length extended outer tubes eliminate the need for extensions, reducing the number of joints in the drill string for improved reliability.
4. Improve driller health and safety with reduced manual handling time and a better ergonomic position when reading core orientations.
5. Make faster decisions on the direction of your hole with more frequent dip measurements.

## Take Core. Take Control.

Veracio has a living legacy of delivering innovation in drilling technology. As a tool in Veracio's new line of instrumentation, TruCore UPIX is supported by a hands-on team of experts with professional backgrounds in drilling, geology, and engineering.

# Co TruCore™ Barrel Options

## Standard

The standard barrel option is available in dedicated diameters corresponding to B, N, and H size hole applications. These barrel options combine to cover the complete range of hole sizes from B to P with size-specific inner tube adapters and check valve systems.



## ONE

The ONE option is available in a single N size barrel configuration but can cover the complete range of hole sizes from N to P with field-replaceable grease caps, inner tube adapters, and check valve systems.

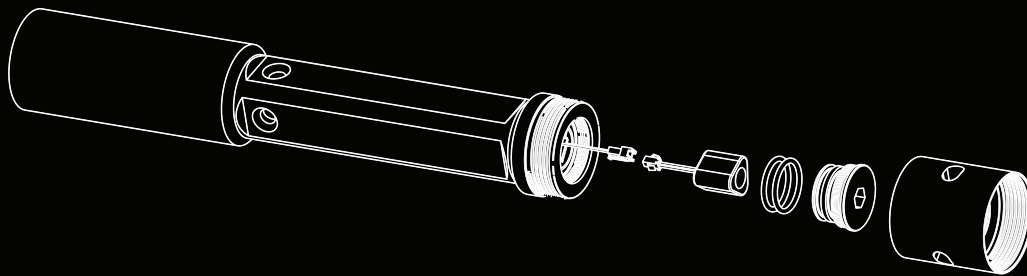
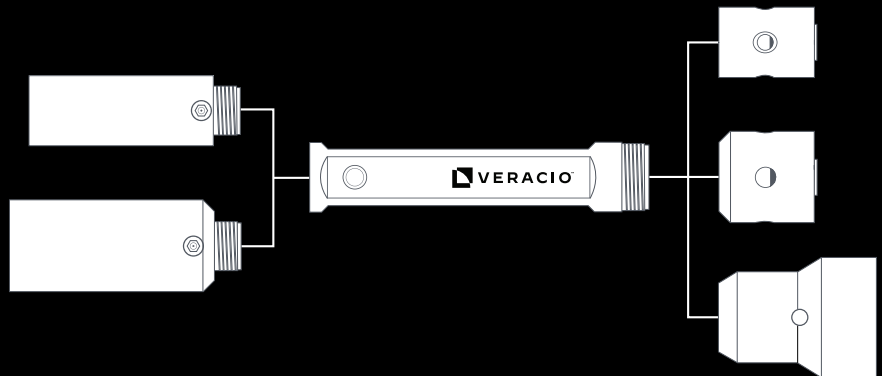

# Co TruCore UPIX™ Audit Data

## Audit Data Option

TruCore UPIX™ is now available with optional audit data export functionality to provide a complete digital record of every orientation.

Audit data-enabled handhelds are fully backwards compatible with all TruCore UPIX tools. The audit data functionality is unlocked through the charging docks featuring a USB port. Once downloaded, the data can be accessed using Microsoft Excel.

\* Microsoft and Excel are trademarks of Microsoft

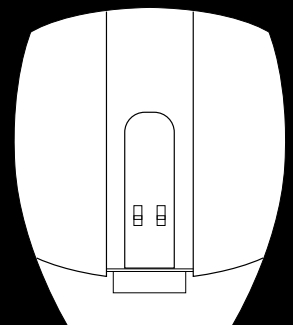
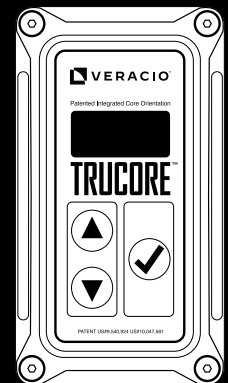

# Kit Contents

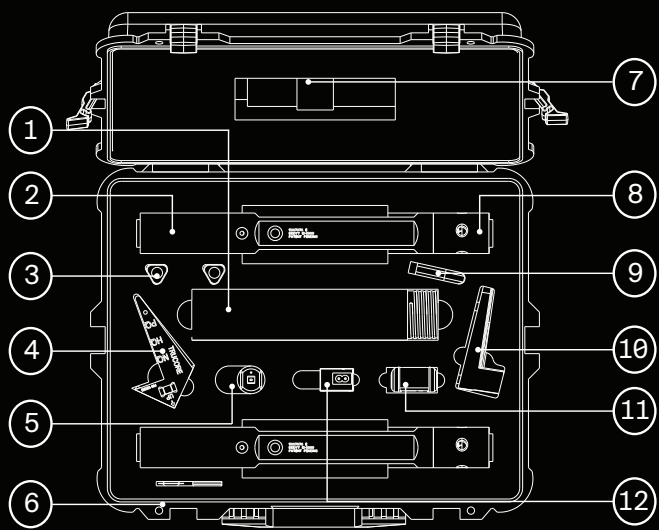

ID	Description
1*	Extension Barrel
2*	2 x TruCore UPIX™ Tools
3	2 x Spare Batteries
4	Level Finder
5	Car Charger
6	O-ring Replacement Kit
7	User Guide & Certificate of Conformance
8*	2 x Inner Tube Adapters with Check Valve Installed
9	Allen Key
10	Handheld Charging Dock
11	TruCore UPIX™ Handheld Unit
12	Power Pack with Electrical Cord

\*ONE kit configurations may include multiple sizes within the kit or shipped seperately to cover the sizes requested.

TruCore UPIX Is Offered In Sizes B Through To P

# Specifications

CORE SIZES	
BQ™, BQTK, NQ, NQ2, NQ3, NTW, HQ, HQ3, HTW, PQ, PQ3, LTK60	
DIMENSIONS	
Kit	
Length x width x height	546 x 420 x 203 mm
Handheld	
Length x width x height	110 x 63 x 31mm
AUDIT DATA TABLE	
Orientation Data	
Format for Successful Orientation Event	
Date	
Time	
Hole ID	
Pass Counter	
Depth	
Event (Successful Orientation)	
Dip	
Temperature	
GTF	
Events Logged	
Start Survey	
Mark Survey	
Successful Orientation	
Pass counter reset	
Data Downloaded	
ACCURACY	
Range	0 to ± 85° dip
Accuracy	± 5° RMS
Dip	± 2.5°
TEMPERATURE RATING	
Downhole instrument	Operating -30°C to +80°C
Handheld	Operating -20°C to +50°C
DEPTH RATING	
Maximum depth	4216m
Housing pressure	41.4 MPa (6000psi)
BATTERY	
Downhole instrument	User replaceable, non-rechargeable lithium
Storage	Up to 10 years
Normal use	3 months
Handheld	Rechargeable lithium ion
Normal use	1 week per full charge

Q is a trademark of Boart Longyear

